



SERIE 111 ■

COUPLINGS, MULTICOUPLINGS & MOULD COOLING PRODUCTS

KUPPLUNGEN, MULTIKUPPLUNGEN & KÜHLUNGSELEMENTE FÜR WERKZEUGE



Interchangeability - Kompatibilität zu anderen
TEMA 3800, TEMA 5000, TEMA 7500,
TEMA 10000

Temperature Range - Temperaturbereich
-25 °C + 100 °C

Working Pressure - Betriebsdruck
50-350 bar

Flow capacity - Nennweite
NW - 10, NW - 13, NW - 20, NW - 25

Standard version For Socket
Brass Nickel Pl.

Standard version For Plug
Steel Hardened, Zinc Pl.

Options - Optionen
Seals: FPM
Sleeve: Brass Nickel Plated

For optional orders please add the symbol of your option end of the order no. Bei Bestellungen Kennbuchstabe bitte hinzufügen
For full flow option please select 111.10 DGF 17

For operation under pressure please put -PD at the end of the code. (Example: 111.10 DGB 17-PD)

Material - Material

- Socket - Kupplungsgrundkörper : Brass, Nickel Plated
- Sleeve - Hülse : Steel Hardened, Zinc Plated
- Valve - Ventil : Brass
- Springs - Federn : AISI 301
- Seals - Dichtungen : NBR
- Valve Holder - Ventil Halter : Brass
- Plug - Nippel : Steel Hardened Zinc Plated

Coupler Kupplung

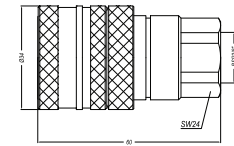

Female Threaded DN10 Socket
DN10 Kupplung mit Innengewinde

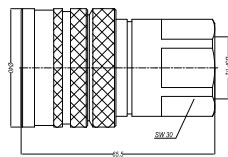

Female Threaded DN13 Socket
With Valve
DN13 Kupplung mit Innengewinde und Ventil

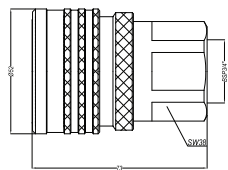

Female Threaded DN20 Socket
With Valve
DN20 Kupplung mit Innengewinde und Ventil

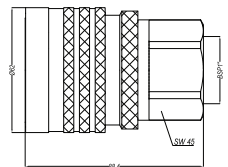

Female Threaded DN25 Socket
With Valve
DN25 Kupplung mit Innengewinde und Ventil

Connection Anschlüsse

Order No / Bestellnr.



SW

Ø

L

BSP 3/8"	111.10 DGB 17	24	34	60
BSP 3/8"	111.10 DGF 17	24	34	60
BSP 3/8"	111.10 DGB 17-PD	24	34	60
BSP 1/2"	111.12 DGB 21	30	40	65.5
BSP 1/2"	111.12 DGB 21-PD	30	40	65.5
BSP 3/4"	111.20 DGB 26	38	52	73
BSP 3/4"	111.20 DGB 26-PD	38	52	73
BSP 1"	111.25 DGB 33	45	62	88.4
BSP 1"	111.25 DGB 33-PD	45	62	88.4



SERIE 111 ■

COUPLINGS, MULTICOUPLINGS & MOULD COOLING PRODUCTS

KUPPLUNGEN, MULTIKUPPLUNGEN & KÜHLUNGSELEMENTE FÜR WERKZEUGE



Interchangeability - Kompatibilität zu anderen
TEMA 3800, TEMA 5000, TEMA 7500,
TEMA 10000

Temperature Range - Temperaturbereich
-25°C + 100°C

Working Pressure - Betriebsdruck
50-350 bar

Flow capacity - Nennweite
NW - 10, NW - 13, NW - 20, NW - 25

Standard version For Socket
Brass Nickel Pl.

Standard version For Plug
Steel Hardened, Zinc Pl.

Options - Optionen
Seals: FPM
Sleeve: Brass Nickel Plated

For optional orders please add the symbol of your option end of the order no.
Bei Bestellungen Kennbuchstabe bitte hinzufügen
For full flow option please select 111.10 DUF 17

For operation under pressure please put -PD at the end of the code.
(Example: 111.10 DUB 17-PD)

Material - Material

- Socket - Kupplungsgrundkörper : Brass, Nickel Plated
- Sleeve - Hülse : Steel Hardened, Zinc Plated
- Valve - Ventil : Brass
- Springs - Federn : AISI 301
- Seals - Dichtungen : NBR
- Valve Holder - Ventil Halter : Brass
- Plug - Nippel : Steel Hardened Zinc Plated

Plug Nippel

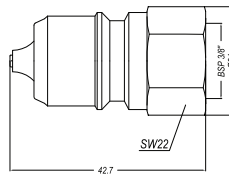

Female Threaded DN10 Plug
DN10 Nippel mit Innengewinde

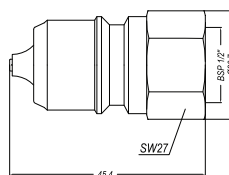

Female Threaded DN13 Plug
With Valve
DN13 Nippel mit Innengewinde und Ventil

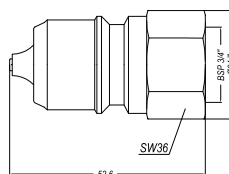

Female Threaded DN20 Plug
With Valve
DN20 Nippel mit Innengewinde und Ventil

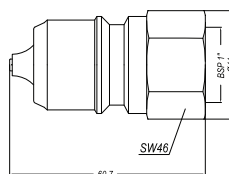

Female Threaded DN25 Plug
With Valve
DN25 Nippel mit Innengewinde und Ventil

Connection Anschlüsse

Order No / Bestellnr.



SW | Ø | L

Connection	Order No / Bestellnr.	SW	Ø	L
BSP 3/8"	111.10 DUB 17	22	24	42.7
BSP 3/8"	111.10 DUF 17	22	24	42.7
BSP 3/8"	111.10 DUB 17-PD	22	24	43.3
BSP 1/2"	111.12 DUB 21	27	26.7	45.4
BSP 1/2"	111.12 DUB 21-PD	27	26.7	46.6
BSP 3/4"	111.20 DUB 26	36	34.7	52.6
BSP 3/4"	111.20 DUB 26-PD	36	34.7	52.6
BSP 1"	111.25 DUB 33	46	44	60.7
BSP 1"	111.25 DUB 33-PD	46	44	60.7