

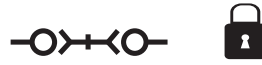

SERIE **095E** ■

PNEUMATIC COUPLINGS
PNEUMATISCHE KUPPLUNGEN



BREATHING SERIE **ATEMLUFT** SERIE
SAFETY TYPE **SICHERHEIT**

Interchangeability - Kompatibilität
RECTUS 95KS, CEJN 344

Temperature Range - Temperaturbereich
-20°C +100°C (-4°F +212°F)

Working Pressure - Betriebsdruck
0 - 35 bar (0 - 508 PSI)

Flow capacity - Nennweite
NW - 7.8

Options - Optionen

- K - Chrome plated - verchromt
- KN - Chemical nickel plated - chemisch vernickelt
- N - Nickel plated - vernickelt
- S - Stainless Steel - Edelstahl (S3:AISI 303, S6:AISI 316TI)
- V - Viton Seal - Viton Dichtung

For optional orders please add the symbol of your option end of the order no.
Bei Optionsbestellungen Kennbuchstabe bitte hinzufügen (Beispiel: 095 EGE 13-K-V)

Material - Material

- Coupler Body - Kupplungsgrundkörper: Brass Nickel Plated - Messing vernickelt
- Back Part - Hinterteil: Brass Nickel Plated - Messing vernickelt
- Sleeve - Hülse: Brass Nickel Plated - Messing vernickelt
- Valve - Ventil: Brass - Messing
- Springs - Federn: Stainless Steel - Edelstahl
- Locking O-Ring - Sprengring: Stainless Steel - Edelstahl
- Pins - Stifte: Stainless Steel - Edelstahl AISI 420
- Seals - Dichtungen: Nitrile (Ni) - NBR (Ni)
- Plug - Nippel: Brass Nickel Plated - Messing vernickelt

In the new coding system, couplings this can be unlocked by pushing the plug into the coupling represented by "E".

Sicherheitskupplungen mit dem "Drück-Sicherheitsmechanismus" werden in Zukunft mit einem zusätzlichen "E" gekennzeichnet.

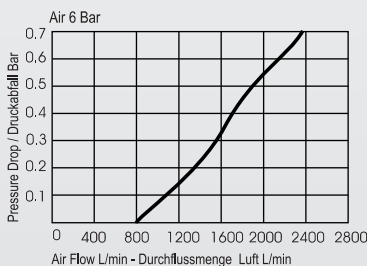

Couplers and Plugs
Kupplungen und Nippel

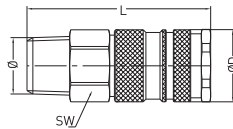

Male Threaded Coupling
Kupplung mit Aussengewinde

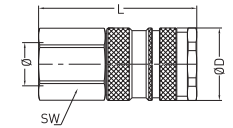

Female Thread Coupling
Kupplung mit Innengewinde

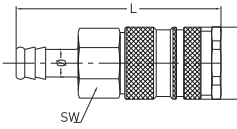

Standard Hose Barb Coupling
Kupplung mit Schlauchtülle

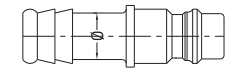

Standard Hose Barb Plug
Nippel mit Schlauchtülle

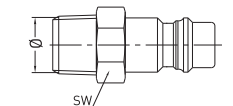

Male Threaded Plug
Nippel mit Aussengewinde

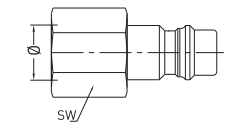

Female Thread Plug
Nippel mit Innengewinde

Connection Anschlüsse	Order No Bestellnr.	SW	L	ØD
--------------------------	------------------------	----	---	----

BSPT 1/4"	095 RGE 13	19	59,3	23
BSPT 3/8"	095 RGE 17	19	60,3	23
BSPT 1/2"	095 RGE 21	22	54,3	23

BSP 1/4"	095 DGE 13	19	54,3	23
BSP 3/8"	095 DGE 17	19	54,3	23
BSP 1/2"	095 DGE 21	24	56,3	23

6 mm - 1/4"	095 HGE 06	19	70,3	23
7 mm - 9/32"	095 HGE 07	19	70,3	23
8 mm - 5/16"	095 HGE 08	19	70,3	23
9 mm - 5/14"	095 HGE 09	19	70,3	23
10 mm - 3/8"	095 HGE 10	19	70,3	23
13 mm - 1/2"	095 HGE 13	19	70,3	23

6 mm - 1/4"	095 HUE 06		46	14
9 mm - 5/14"	095 HUE 09		46	14
10 mm - 3/8"	095 HUE 10		46	14

BSPT 1/4"	095 RUE 13	14	38,5	
BSPT 3/8"	095 RUE 17	17	38,5	

BSP 1/4"	095 DUE 13	17	33	
BSP 3/8"	095 DUE 17	19	33	