

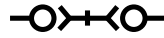

SERIE **038B** ■

PNEUMATIC COUPLINGS
PNEUMATISCHE KUPPLUNGEN



Interchangeability - Kompatibilität
RECTUS 38KB

Temperature Range - Temperaturbereich
-20°C +100°C (-4°F +212°F)

Working Pressure - Betriebsdruck
0 - 35 bar (0 - 508 PSI)

Flow capacity - Nennweite
NW - 15

Option - Optionen

- K - Chrome Plated - verchromt
- KN - Chemical Nickel Plated - chemisch vernickelt
- N - Nickel Plated - vernickelt
- S - Stainless Steel - Edelstahl (S3:AISI 303, S6:AISI 316TI)

For optional orders please add the symbol of your option end of the order no.
Bei Optionsbestellungen Kennbuchstabe bitte hinzufügen (Beispiel: 038 EGB 21-K-S)

Material - Material

Body - Kupplung

Coupler Body - Kupplungsgrundkörper: Brass - Messing

- Back Part - Hinterteil : Brass - Messing
- Sleeve - Hülse : Brass - Messing
- Valve - Ventil : Brass - Messing
- Springs - Federn : Stainless Steel - Edelstahl

Sprengring : Stainless Steel - Edelstahl

Balls - Kugeln : Stainless Steel - Edelstahl AISI 420

Seals - Dichtungen : Nitrile - (Ni) - NBR (Ni)

Plug - Nippel

Plug Profile - Stecker Profil : Brass - Messing

Back Body - Hinterteil : Brass - Messing

Valve - Ventil : Brass - Messing

Spring - Federn : Stainless Steel - Edelstahl

Seal - Dichtungen : Nitrile (Ni) - NBR (Ni)

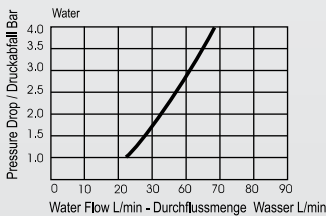
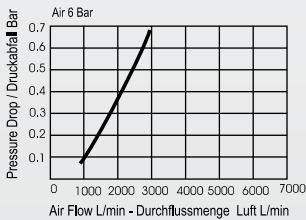

Couplers and Plugs
Kupplungen und Nippel

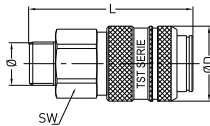

Male Threaded Coupling
Kupplung mit Aussengewinde

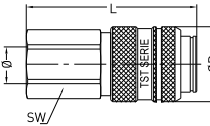

Female Thread Coupling
Kupplung mit Innengewinde

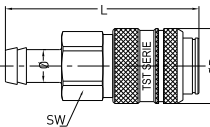

Standard Hose Barb Coupling
Kupplung mit Schlauchtülle

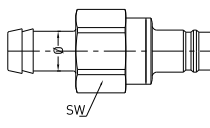

Standard Hose Barb Plug
Nippel mit Schlauchtülle

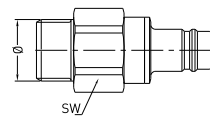

Male Thread Plug
Nippel mit Ausengewinde

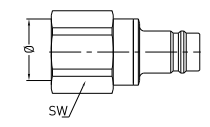

Female Thread Plug
Nippel mit Innengewinde

Connection Anschlüsse	Order No Bestellnr.	SW	L	ØD
-----------------------	---------------------	----	---	----

BSP 1/2"	038 EGB 21	35	89,1	40
BSP 3/4"	038 EGB 26	35	92,1	40
BSP 1"	038 EGB 33	35	92,1	40

BSP 1/2"	038 DGB 21	35	91,1	40
BSP 3/4"	038 DGB 26	34	91,1	40
BSP 1"	038 DGB 33	41	92,1	40

13 mm - 1/2"	038 HGB 13	35	107,1	40
16 mm - 5/8"	038 HGB 16	35	115,1	40
19 mm - 3/4"	038 HGB 19	35	115,1	40
25 mm - 1"	038 HGB 25	35	115,1	40

13 mm - 1/2"	038 HUB 13	35	103
16 mm - 5/8"	038 HUB 16	35	111
19 mm - 3/4"	038 HUB 19	35	111
25 mm - 1"	038 HUB 25	35	111

BSP 1/2"	038 EUB 21	35	85
BSP 3/4"	038 EUB 26	35	88
BSP 1"	038 EUB 33	35	88

BSP 1/2"	038 DUB 21	35	87
BSP 3/4"	038 DUB 26	34	87
BSP 1"	038 DUB 33	41	88